GENERAL MEDICINE

ENTRANCE EXAM 2024/2025



General medicine – Faculty of medical science



[Goce Delcev' University - Stip](http://www.gdu.edu.mk)

Thank you for choosing our University

Faculty of Medical Sciences

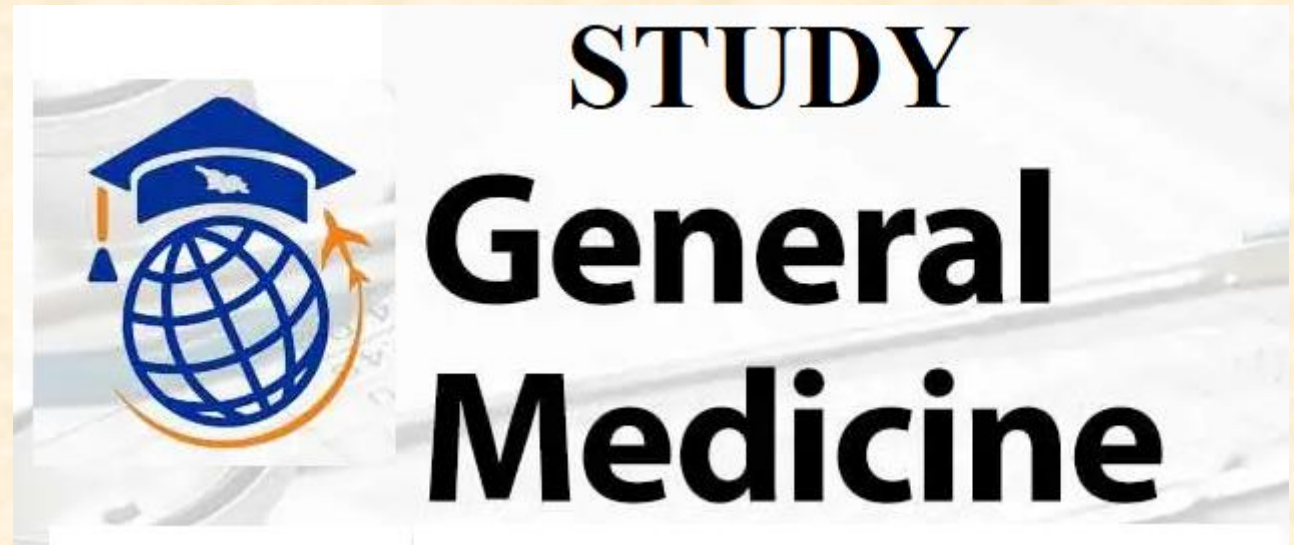

General medicine – Entrance exam

Entrance exam - online

1. **Biology – day 26.08.2024, 10 am, local Macedonian time**
2. **Chemistry – day 27.08.2024, 10 am, local Macedonian time**



General medicine – Entrance exam

Entrance exam

- **60 questions of each subject**
- **2 hours to answer**
- **you do not have to answer the questions in order**
- **you can skip the question in case you have any doubts and return to the question**



General medicine – Entrance exam

Entrance exam – what you should do ?

- 1. An event will be created on Teams**
- 2. Enter the event and turn on the camera**
- 3. You will receive a link that will take you directly to the quiz**
- 4. You will receive a password to start with the test**

General medicine – Entrance exam

Entrance exam

- **For the whole time you will have technical support**
- **In case of any problems write a message on Teams or send an e-mail to
aleksandra.nikolova@ugd.edu.mk**
- **The test solving time will be extended in case of interruption**

**HOW DOES IT LOOK LIKE IN
PRACTISE?**

General medicine – Entrance exam

Entrance Exam Demo

Login Screen

Log in to УГД Е-УЧЕЊЕ

1 → Your email address

2 → Default password : EntranceExam2023

3

[Lost password?](#)

Log in using your account on:

English (en) ▾

?

Change language

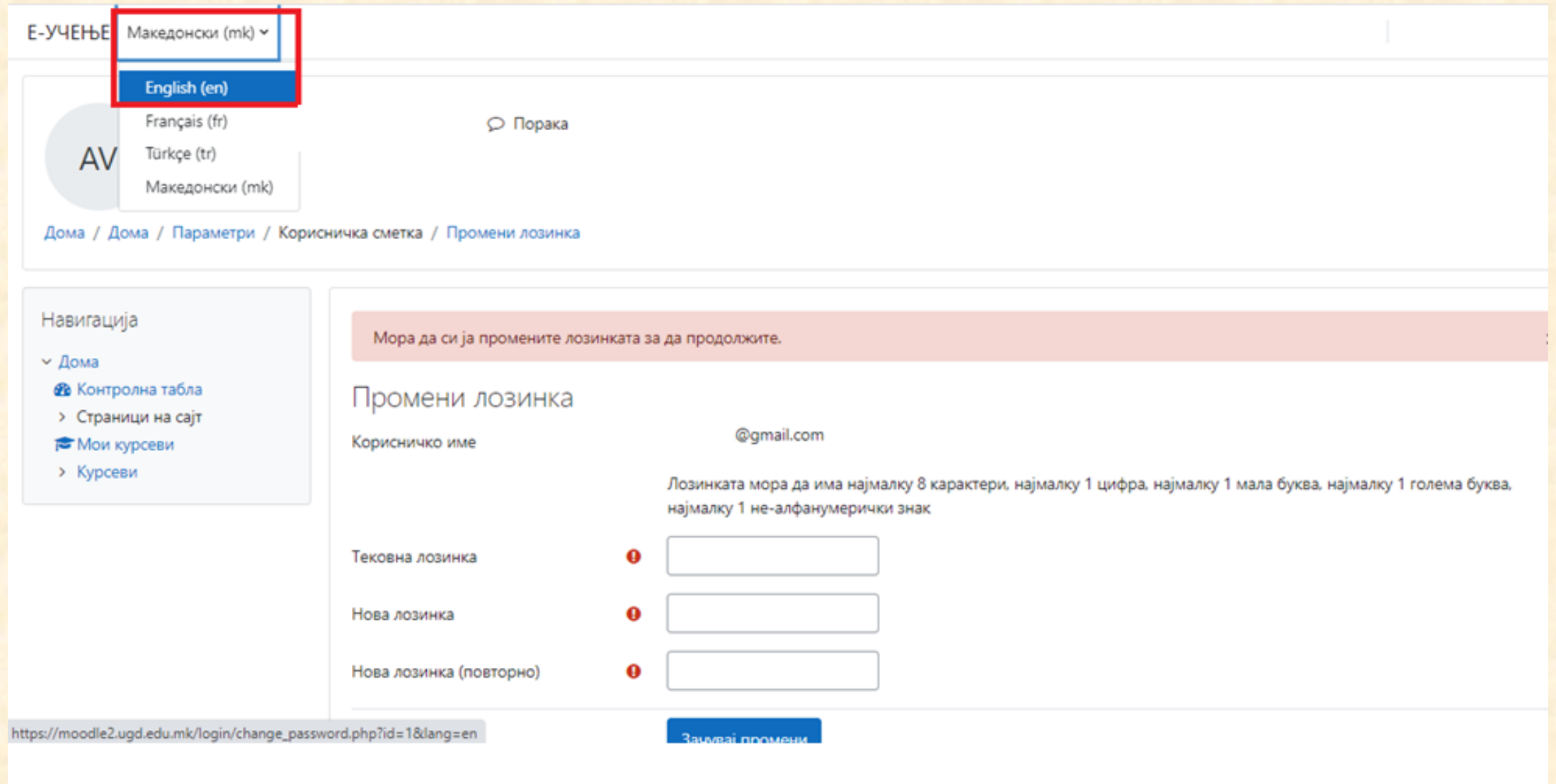

The screenshot shows the Moodle user interface. At the top left, the text "E-УЧЕЊЕ" is visible. A language selection dropdown menu is open, showing "Македонски (mk)" as the current selection. The "English (en)" option is highlighted in blue. Other options include "Français (fr)", "Türkçe (tr)", and "Македонски (mk)". Below the dropdown, there is a profile picture with the initials "AV" and a "Порака" (Message) icon. A breadcrumb trail reads "Дома / Дома / Параметри / Корисничка сметка / Промени лозинка". On the left, a "Навигација" (Navigation) sidebar lists "Дома", "Контролна табла", "Страници на сајт", "Мои курсеви", and "Курсеви". The main content area features a red warning banner: "Мора да си ја промените лозинката за да продолжите." Below this is the "Промени лозинка" (Change password) form. The "Корисничко име" (Username) field contains "@gmail.com". A password requirement message states: "Лозинката мора да има најмалку 8 карактери, најмалку 1 цифра, најмалку 1 мала буква, најмалку 1 голема буква, најмалку 1 не-алфанумерички знак". There are three input fields for "Тековна лозинка" (Current password), "Нова лозинка" (New password), and "Нова лозинка (повторно)" (New password (confirm)), each with a red information icon to its left. At the bottom right, there is a blue button labeled "Задивај промени" (Save changes). The URL at the bottom left is "https://moodle2.ugd.edu.mk/login/change_password.php?id=1&lang=en".

Е-УЧЕЊЕ Македонски (mk) ▾

English (en)

Français (fr)

Türkçe (tr)

Македонски (mk)

Порака

Дома / Дома / Параметри / Корисничка сметка / Промени лозинка

Навигација

- Дома
- Контролна табла
- Страници на сајт
- Мои курсеви
- Курсеви

Мора да си ја промените лозинката за да продолжите.

Промени лозинка

Корисничко име @gmail.com

Лозинката мора да има најмалку 8 карактери, најмалку 1 цифра, најмалку 1 мала буква, најмалку 1 голема буква, најмалку 1 не-алфанумерички знак

Тековна лозинка

Нова лозинка

Нова лозинка (повторно)

Задивај промени

https://moodle2.ugd.edu.mk/login/change_password.php?id=1&lang=en

Change password

[Home](#) / [Home](#) / [Preferences](#) / [User account](#) / [Change password](#)

Navigation

- Home
 - Dashboard
 - Site pages
 - My courses
 - Додипломски студии

You must change your password to proceed. ×

Change password

Username avelinov2@gmail.com

The password must have at least 8 characters, at least 1 digit(s), at least 1 lower case letter(s), at least 1 upper case letter(s), at least 1 special character(s) such as as *, -, or #

Current password 1 ! **Default password: EntranceExam2023**

New password 2 ! **Your new password**

New password (again) 3 ! **Repeat the new password**

4

! Required

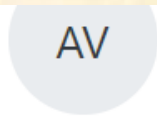

ALEXANDAR VEINOV

[Home](#) / [Home](#) / [Preferences](#) / [User account](#) / [Change password](#)

Navigation

▼ Home

 [Dashboard](#)

> [Site pages](#)

▼ [My courses](#)

> [Додипломски студии](#)

Password has been changed

[Continue](#)

Quiz attempt

Tect

Mark as done

Opened: Wednesday, 30 August 2023, 9:00 AM

Closes: Wednesday, 30 August 2023, 4:00 PM

Attempt quiz

Attempts allowed: 1

To attempt this quiz you need to know the quiz password

Time limit: 1 hour

Enter quiz password

The image shows a 'Start attempt' dialog box overlaid on a quiz page. The dialog box contains the following text and elements:

- Start attempt** (title bar)
- Password** (section header)
- To attempt this quiz you need to know the quiz password
- Quiz password** (label above a text input field containing four dots)
- Time limit** (section header)
- Your attempt will have a time limit of 1 hour. When you start, the timer will begin to count down and cannot be paused. You must finish your attempt before it expires. Are you sure you wish to start now?
- Start attempt** (blue button)
- Cancel** (grey button)

Annotations in red:

- A red box highlights the 'Quiz password' input field.
- A red box on the right contains the text: 'Enter the password for the exam', 'Password for biology: 001', and 'Password for chemistry: 002'. A red arrow points from this box to the password input field.
- A red box highlights the 'Start attempt' button.

Background text (partially visible):

- Тест
- Mark as done
- Opened: Wednesday 1
- Closes: Wednesday
- Attempt quiz
- Attempts allowed: 1
- To attempt this quiz
- Time limit: 1 hour 2

Entrance Exam Start (this test is an example)

E-УЧЕЊЕ English (en) ▾

Quiz navigation

AV

Aleksandar Velinov

1 2 3 4 5 6

7 8

Finish attempt ...

Back

Time left 0:59:03

Question 1
Not yet answered
Marked out of 2.00
Flag question

Колку денови има месец Декември?

a. 29

b. 28

c. 31

d. 30

Clear my choice

Question 2
Not yet answered
Marked out of 2.00
Flag question

Кои број е парен?

a. 10

b. 3

c. 5

d. 1

Clear my choice

Next page

E-УЧЕЊЕ English (en) 🔔 💬 ⌵

answered
Marked out of 3.00
[Flag question](#)

a. moznoe
 b. da

Time left 0:57:35

Question 4
Not yet answered
Marked out of 3.00
[Flag question](#)

zimata e ladna

a. ne
 b. da

[Next page](#)

[← Announcements](#)

Jump to... ⌵

Finish attempt

English (en)

answered
Marked out of 3.00
[Flag question](#)

True
 False

Time left 0:55:05

Question 8
Not yet answered
Marked out of 3.00
[Flag question](#)

moze da se zivee bes voda

True
 False

Previous page

Finish attempt ...

[← Announcements](#)

Jump to...

Submit all and finish

3	Not yet answered
4	Not yet answered
5	Not yet answered
6	Not yet answered
7	Not yet answered
8	Not yet answered

[Return to attempt](#)

Time left 0:53:33

This attempt must be submitted by Wednesday, 30 August 2023, 3:33 PM.

[Submit all and finish](#)

Submit all and finish

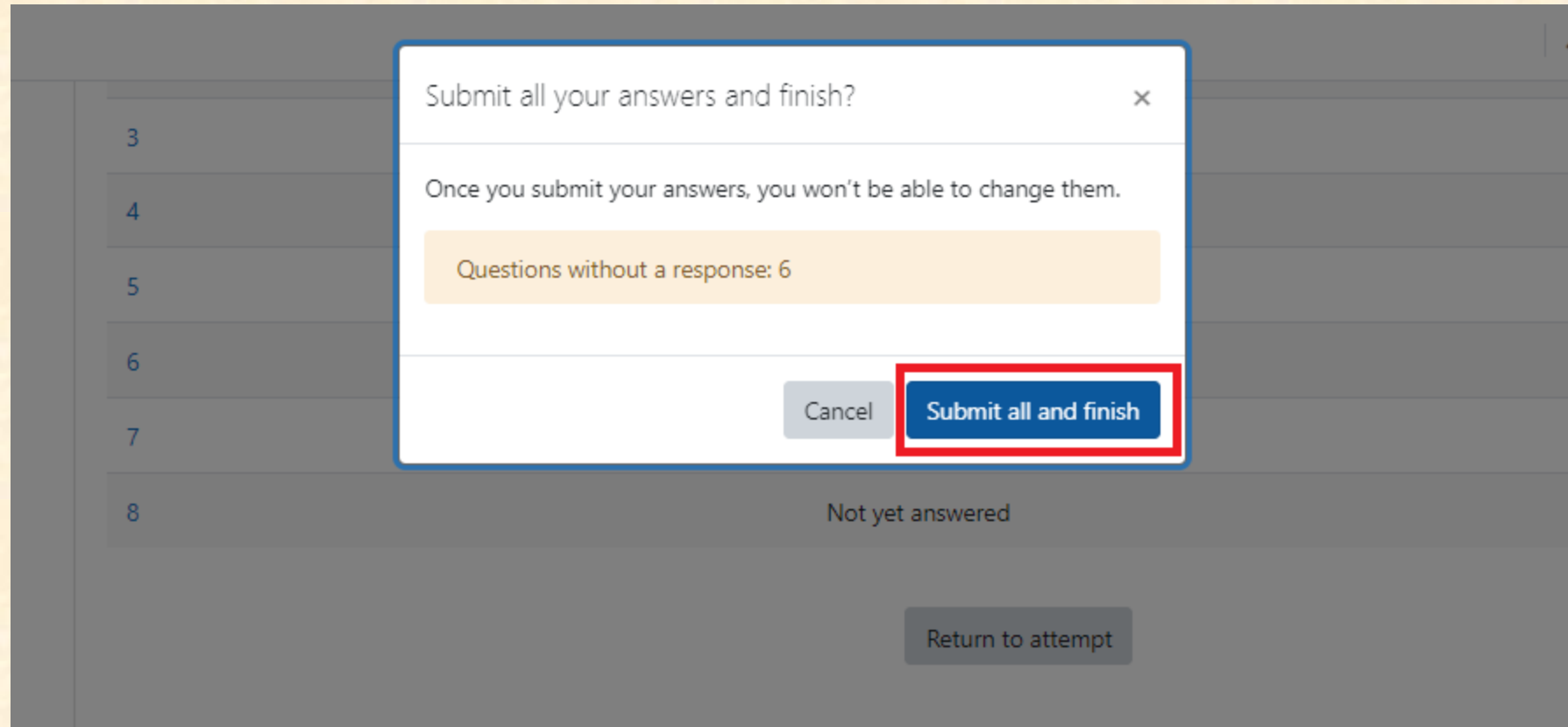

Final results

Tect

Mark as done

Opened: Wednesday, 30 August 2023, 9:00 AM
Closes: Wednesday, 30 August 2023, 4:00 PM

Attempts allowed: 1

To attempt this quiz you need to know the quiz password

Time limit: 1 hour

Summary of your previous attempts

State	Grade / 20.00	Review
Finished Submitted Wednesday, 30 August 2023, 2:42 PM	4.00	

Your final grade for this quiz is 4.00/20.00.